

TANK CLEANING HOSE

Introduction

The mandrel-built tank cleaning hose is designed for use with automated and manual cleaning systems in industrial tanks, vessels, and tankers. The hose is made from durable materials, such as EPDM rubber, to withstand high temperatures, chemical exposure, and mechanical stress. The primary function is to transport water or cleaning agents from a source, such as a pump or hydrant, to a tank cleaning machine. Also, with a hose saddle to hold the machine in position within the tank during tank cleaning operations.

Application

Tank cleaning hoses are widely used in:

- Fixed and portable tank cleaning.
- Petroleum/crude oil and chemical tankers for removing sludge, residues, and contaminants.
- Bulk carriers and offshore installations.
- Marine vessels and inland barges for routine maintenance and safety compliance.
- Food and beverage processing tanks for hygienic cleaning during CIP (Clean-in-Place) operations.
- Pharmaceutical and cosmetic industries where sterile environments are critical.

Working principle

The hose connects to a water or chemical source (refer to chemical resistance chart) and channels the fluid to a tank cleaning machine. The machine then rotates or oscillates to spray the tank's interior surfaces with high-pressure jets, ensuring full coverage and effective cleaning. The hose can also be used as a suspension line to position the cleaning device within the tank using the hose saddle.

Benefits

- Chemical and temperature resistance, especially with EPDM.
- Compliance with industry standards, such as ISGOTT, for oil tankers.
- Versatility for use with hot water, steam, or chemical additives.
- Applicable for animal or vegetable produce and alcoholic drinks.
- Electrical continuity via embedded bonding wires for safety in hazardous environments.



Related product

- Chemical hoses and other hoses
- Hose saddles, for example SC SADDLE
- Portable tank cleaning machines, for example SC 15TW and SC 45TW
- Fixed tank cleaning machines, for example SC 30T and SC 90T2

Accessories

The hose comes with a wide range of accessories:

- Adapters
- Hydrant connections

Technical data

Tube:	Black, smooth, synthetic rubber, (EPDM) resistant to the most common detergents and heat.
Reinforcement	High strength textile plies and two stainless steel wires trailing off from each end.
Cover:	Black, smooth rubber, resistant to heat, abrasion, common detergents, ozone and marine weather. Fabric impression.
Working pressure:	20 bar
Burst pressure:	60 bar
Temperature:	-30 °C to +95 °C
Marking:	Scanjet branding, embossed tape according to norm. Length marked on hose. Serial no. marked on coupling.

Cutaway drawing

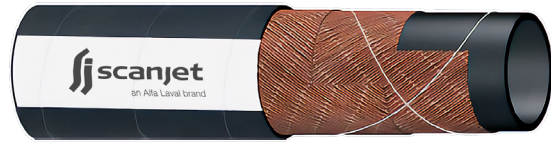

Dimensions

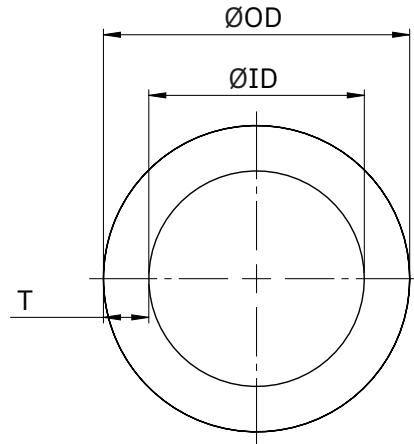

Sizes and Weights

Sizes and Weights

Model/Part no.	OD, Outer Diameter (mm)	ID, Inner Diameter (mm)	T, Thickness (mm)	Bending radius – Liquid filled hose (mm)	Bending radius – Empty hose (mm)	Weight (kg/m)
HOSE 15 HD	54 mm	38 mm	8 mm	300 mm	460 mm	1.42 kg/m
HOSE 20 HD	67 mm	51 mm	8 mm	400 mm	610 mm	1.80 kg/m

Issue: Scanjet-Tank_cleaning_hose-datasheet_v20251103

This document and its contents are subject to copyrights and other intellectual property rights owned by Scanjet Marine & Systems AB or any of its affiliates (jointly "Scanjet"). No part of this document may be copied, re-produced or transmitted in any form or by any means, or for any purpose, without Scanjet's prior express written permission. Information and services provided in this document are made as a benefit and service to the user, and no representations or warranties are made about the accuracy or suitability of this information and these services for any purpose.

© Scanjet Marine & Systems AB. All rights are reserved.